

Revision Notes				
R1 - MANUFACTURING LABEL DETAILS ADDED, FRAME UPDATED, KIT TABLE ADDED, NOTES REVISED, AS PER P1648				
APA: A. WRIGHT	Drawn: B. STROHMER	Checked: E. MATHEW	Approved: D. FOALE	Date: 16/07/25

ITEM	PART NO	QTY	MODEL / DESCRIPTION
①	(7547)	1	NS-2-E / ECU ONLY
②	-	1	25x55 NS-2-IG / INSTALLATION GUIDE (NOT SHOWN)
③	(7581)	1	25x55 NSDS-LBL / DASH STICKER (NOT SHOWN)

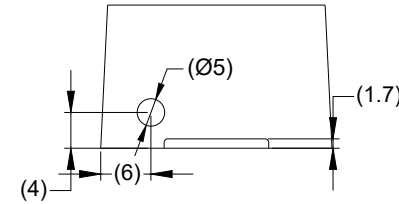

RED (12/24 VDC)  
 BLACK (GROUND)  
 YELLOW (OUTPUT TO ALARM, 12/24 VDC)

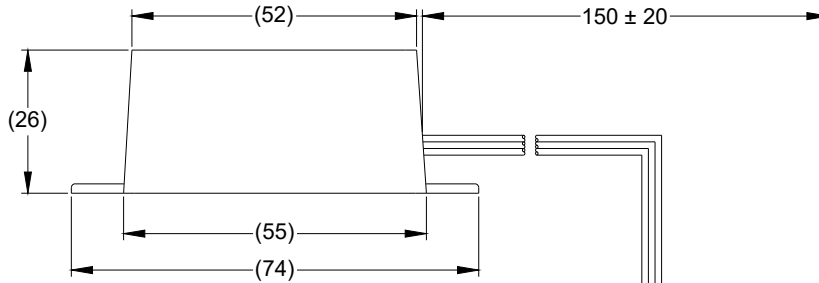
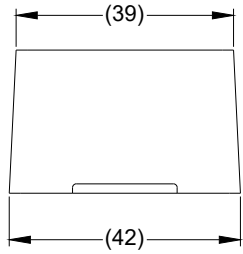
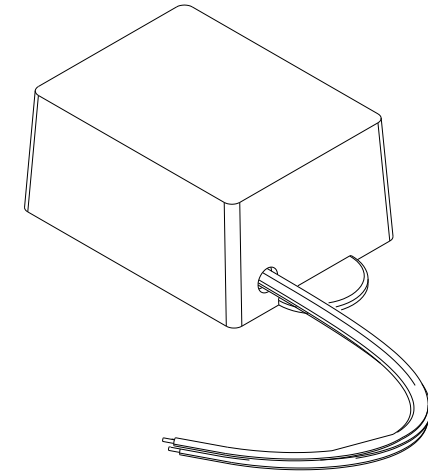
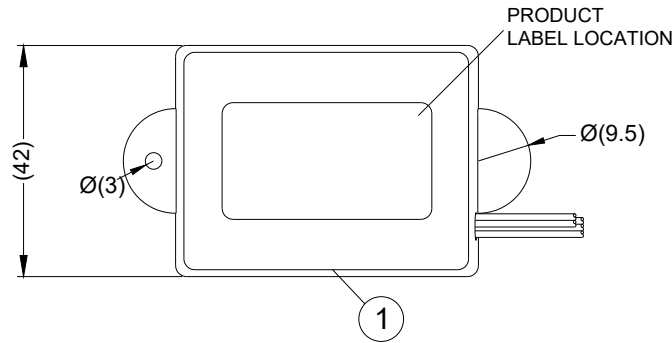
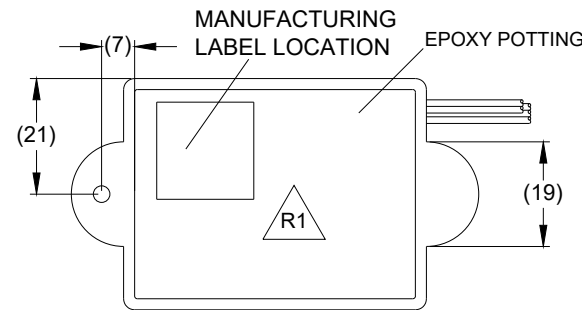

**SPECIFICATION**

RATED VOLTAGE: 12 AND 24 VOLTS DIRECT CURRENT (WORKING VOLTAGE RANGE 10 THRU 30 VOLTS)  
 RATED CURRENT: 300 MILLIAMPERES OR LESS  
 MAX CURRENT HANDLING: 10 AMPERES  
 CABLE THICKNESS: POWER CABLES 16/0.2MM

**OPERATION**

WHEN THE VEHICLE IS ENGAGED IN REVERSE TWICE WITHIN 1 SECOND  
 THE ALARM OUTPUT WILL BE MUTED UNTIL THE VEHICLE IS TAKEN OUT OF REVERSE.

**NOTES:**

- DIMENSIONS IN MM
- POTTING SHOULD FULLY ENCAPSULATE THE PCB ALTHOUGH THE RELAY CAN PROTRUDE
- HOLE LOCATIONS ON THE HOUSING ARE THE RESPONSIBILITY OF THE ASSEMBLY PLANT AND SHOULD ADHERE TO DRAWING "GPL2-DRILL ISSUE 1"
- FOR LABEL AND PACKAGING DETAILS REFER TO MASTER BOM.
- ANY CUSTOMER MODIFICATION OF THIS PRODUCT CAUSING SUBSEQUENT FAILURE IS NOT A LIABILITY OF BRIGADE ELECTRONICS PLC.



**PROPRIETARY NOTICE**

THIS DESIGN AND TECHNICAL INFORMATION APPEARING ON THIS DRAWING IS THE PROPERTY OF BRIGADE ELECTRONICS, AND IS DISCLOSED IN CONFIDENCE. IT IS NOT TO BE COPIED, REPRODUCED, REVEALED TO OR EXPROPRIATED BY OTHERS, EITHER IN WHOLE OR IN PART WITHOUT THE EXPRESS WRITTEN CONSENT OF BRIGADE ELECTRONICS.

**Brigade**  
 brigade-electronics.com

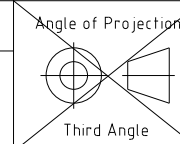

Sheet 1 of 1	Assembly Pl Approval A. HEEDELE	Approved by D. KERAI	Checked by L. BRAR	Drawn by M. BUTLER
Customer Approval -	Angle of Projection 	Units mm	Scale N/A	Released 03/02/12
		Status RELEASED	NS-2	
		Part No 0334	BE-001913-01-12	
		Assembly Ref A1092A		